

LTMS RAIN GARDEN
 TOTAL PONDING AREA = 671 FT²
 PLANTING BED DEPTH (SOIL) = 1'
 MULCH LAYER = 2"
 WATER PONDING DEPTH (SHALLOW WATER PONDING AREA) = 6"
 FREEBOARD = 3"
 TOTAL DEPTH = 12" + 2" + 6" + 3" = 23" = 1.91667' = 1' 11"
 TOTAL VOLUME = 671 FT² × 1.91667' = 1286.10 FT³
 TOTAL SOIL EXCAVATION (CUT) = 4.8 YD³
 MAJOR AXIS (WIDTH) = 18'
 MINOR AXIS (LENGTH) = 47.5'
 DISTANCE FROM MEDIA CENTER TO EDGE = 13.0'
 DISTANCE FROM BRICK WALL TO EDGE = 10.0'
 DISTANCE FROM ENCLOSED WALKWAY TO EDGE = 23.8'
 DISTANCE FROM BRICK UTILITY BUILDING TO EDGE = 13.6'

BERM DEPTH = 1' - 1.5' (DEPTH GREATEST IN CENTER OF BERM)
 BERM LOCATED AROUND 3/4 OF RAIN GARDEN MINOR AXIS LENGTH (35.598')
 DISTANCE FROM EDGE OF RAIN GARDEN TO BERM = 2.81'
 DISTANCE FROM MEDIA CENTER TO EDGE OF BERM = 10.1'

RAIN GARDEN CROSS-SECTION

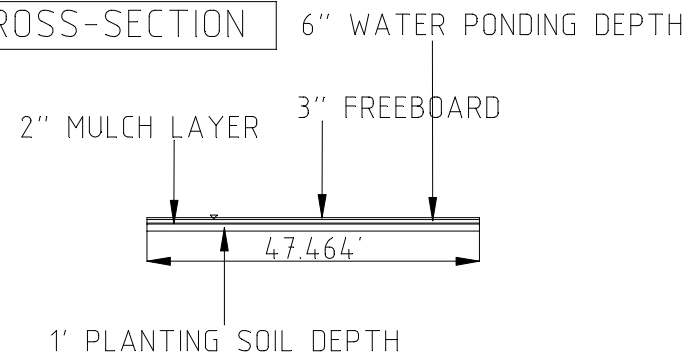

ELLIPSE CENTER (X = 37.5' AND Y = 22.9')

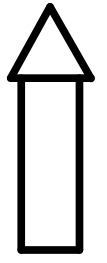

NORTH

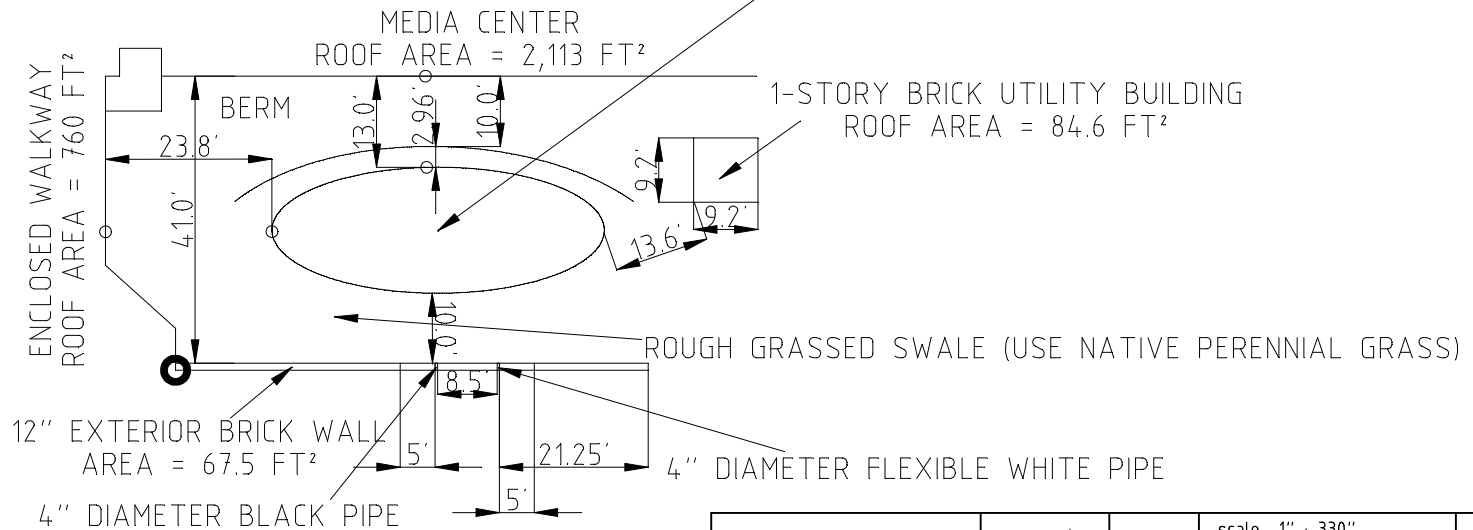

ORIGIN (0,0) = INTERSECTION OF ENCLOSED WALKWAY AND BRICK WALL

			scale 1" : 330"	
			LTMS Rain Garden Designed by Irucka Embry Principal, EcoC ² S	
			1/1 sheet	